

**PRINCIPAL PARTICULARS**

LENGTH HULL	55.0 metres
LENGTH W.L.	50.4 metres
BEAM MOULDED	9.0 metres
DRAFT MOULDED	2.3 metres
DRAFT MAX (PROPS)	2.9 metres
LIGHTSHIP DISP. APPROX.	262 tonnes
DELIVERED DISP. APPROX.	340 tonnes
CREW ACCOMMODATION	22
CIVIL OFFICERS	4
ADDITIONAL PERSONNEL	12

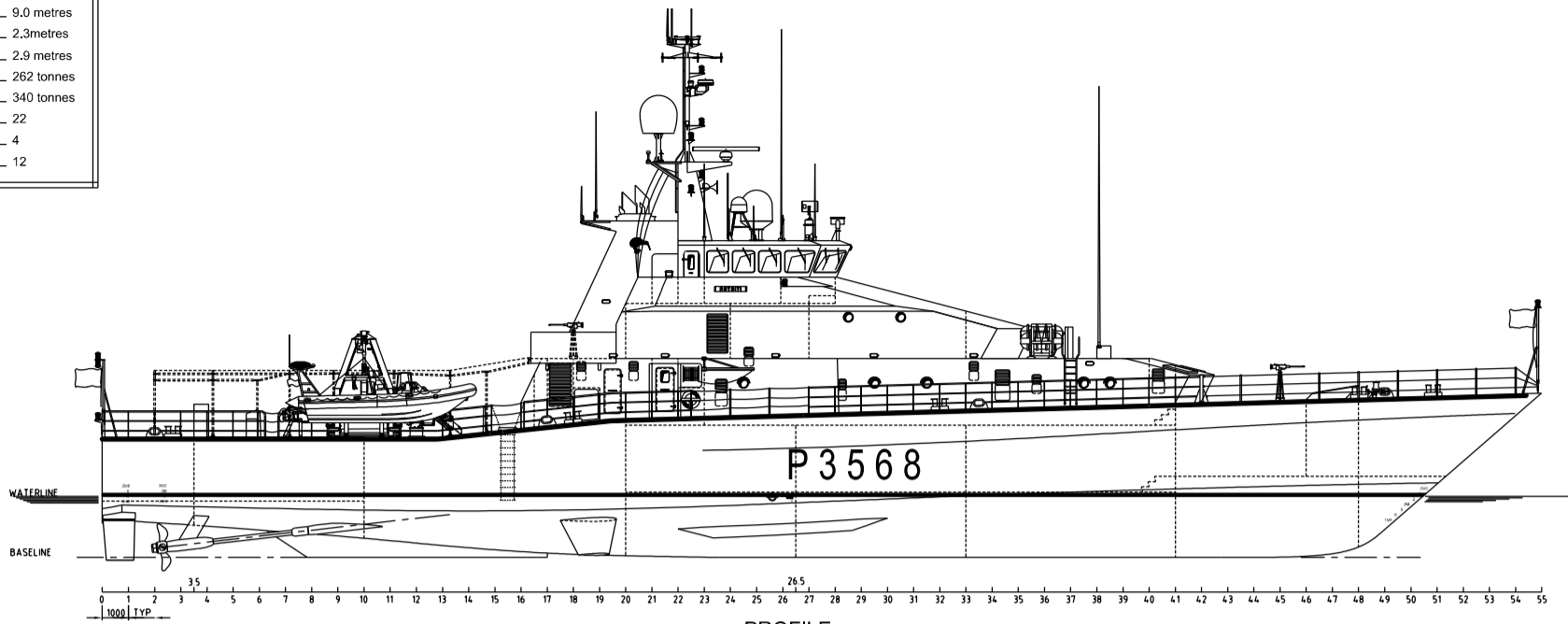

PROFILE

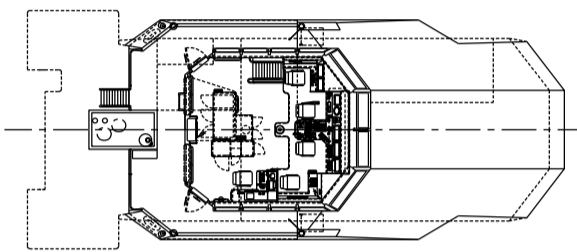

02-DECK

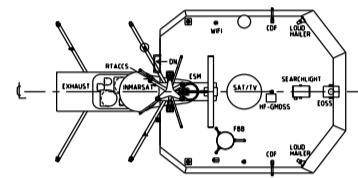

03-DECK

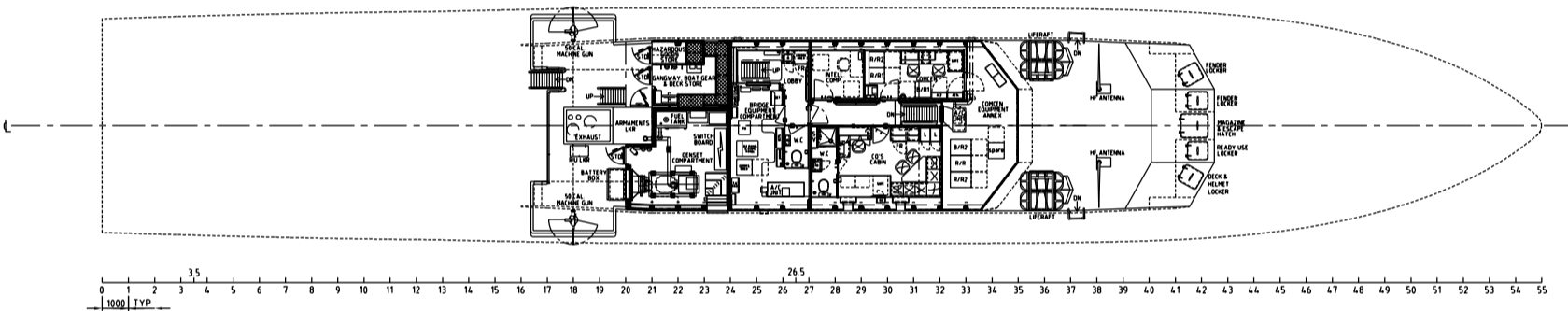

01-DECK

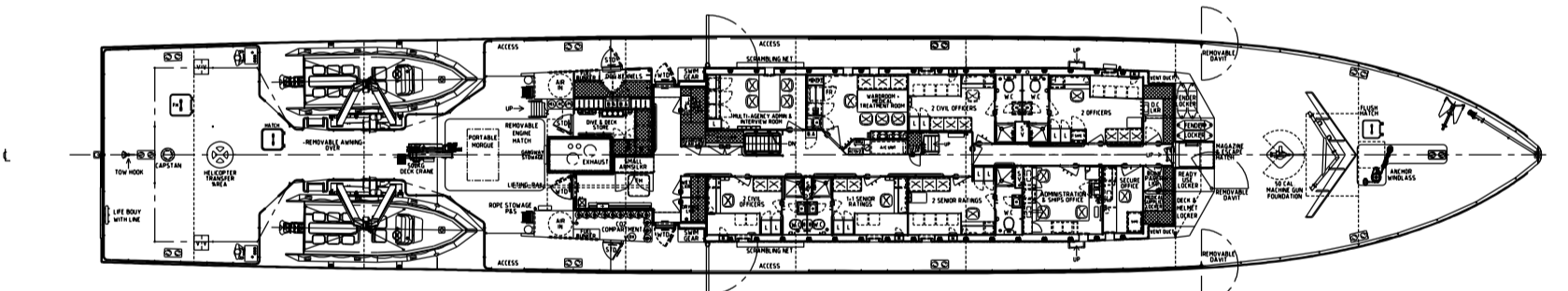

1 DECK

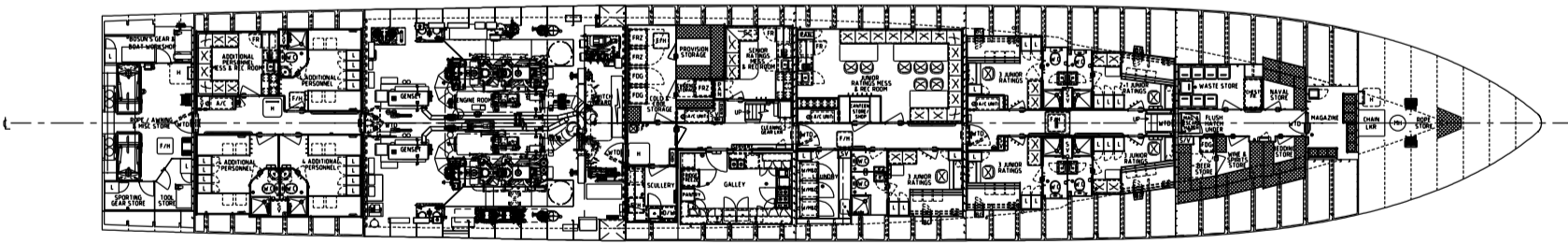

2 DECK

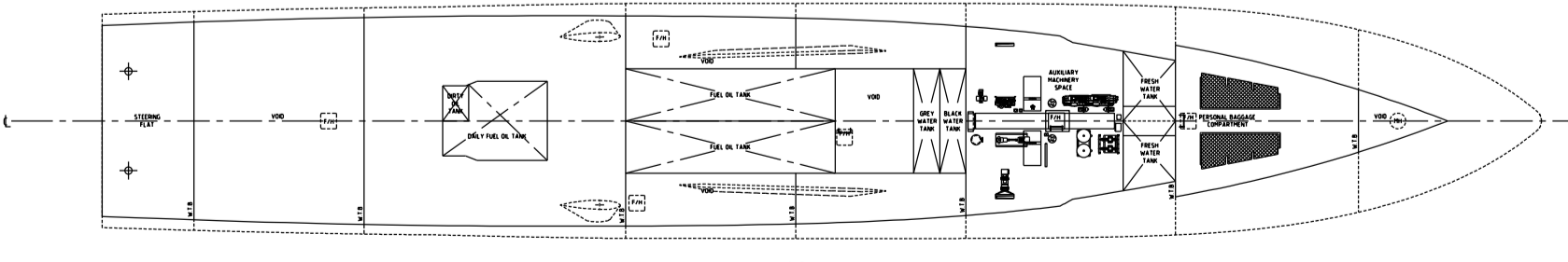

BELOW 2 DECK

PROJECT DRAWING No  
**6203-00101-DH-000035**

5	UPDATED FOR CCP170015181 (ESM) 170047306 (FBB), CCP170011167(WFI) & CCP 2858(RTACCS) INSTALL	09/13	GP
4	GENERAL UPDATE AS PER IPV GA CHANGE LIST	28 APR 07	
3	REVISION AS PER IPV GA CHANGE LIST	19 MAY 05	MB
2	GENERAL UPDATE	18 JAN 05	MB
1	FIRST ISSUE	15 APRIL 03	MB
REV	DESCRIPTION	DATE	DRN

**GENERAL ARRANGEMENT**

DRN	MB,B,R,B,P	CHKD	
DATE	15 APRIL 03	APPD	
SCALE	1:100	AO	
PROJECT	DRAWING No.	REV	
355	101-001	5	

This drawing and all information shown herein are the exclusive property of Teles Defence Pty Ltd Marine Division, and is submitted only on a confidential basis. The recipient agrees not to reproduce the drawing, to return it upon request and that no disclosure of the drawing or information shown herein will be made to a third party without prior written consent from Teles Defence Pty Ltd Marine Division.

UNLESS OTHERWISE STATED TOLERANCES AS STATED ON REFER S-04-01